



Aluminium [AlMg2,5]

Polished



Steel

Zinc plated

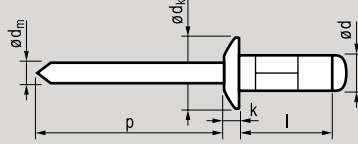

PLIA I multigrip I dome head

Ø d	l		Item nr.	Ø d _k	k	Ø d _m	p		
[mm]	[mm]	[mm]		[mm]	[mm]	[mm]	[mm]	[N]	[N]
3,0	6,0	0,5-3,0	10013006						
[+0,05/-0,13]	8,0	0,5-5,0	3008						
	10,0	2,5-7,0	3010	6,0	≤1,4	~1,70	≥27	655	520
Ø 3,1 [3,3 max]	12,0	4,5-9,0	3012	[+/-0,24]					
3,2	6,0	0,5-3,0	10013206						
[+0,05/-0,13]	8,0	0,5-5,0	3208						
	9,5	2,0-6,5	3209						
Ø 3,3 [3,5 max]	10,0	2,5-7,0	3210						
	11,1	3,5-8,0	3211	6,0	≤1,4	~1,78	≥27	980	680
	12,0	4,5-9,0	3212	[+/-0,24]					
	12,7	5,5-9,5	3213						
	14,0	6,5-11,0	3214						
	16,0	8,5-13,0	3216						
4,0	6,0	0,5-2,5	10014006						
[+0,05/-0,13]	8,0	0,5-4,5	4008						
	9,5	1,0-6,0	4009						
Ø 4,1 [4,3 max]	10,0	1,5-6,5	4010						
	12,0	3,5-8,5	4012						
	12,7	4,0-9,5	4013	8,0	≤1,7	~2,18	≥27	1.600	1.150
	14,0	5,5-10,5	4014	[+/-0,29]					
	16,0	7,5-12,5	4016						
	17,0	8,5-13,5	4017						
	18,0	9,5-14,5	4018						
	20,0	11,5-16,5	4020						
4,8	10,0	0,5-5,0	10014810						
[+0,05/-0,13]	10,3	0,5-5,5	4811						
	12,0	2,0-7,0	4812						
Ø 4,9 [5,2 max]	14,0	4,0-9,0	4814						
	15,1	5,0-10,5	4815						
	16,0	6,0-11,0	4816	9,5	≤2,0	~2,78	≥27	2.350	1.500
	17,0	7,0-12,0	4817	[+/-0,29]					
	18,0	8,0-13,0	4818						
	20,0	10,0-15,0	4820						
	22,0	12,0-17,0	4822						
	24,0	14,0-19,0	4824						
	24,8	14,5-19,5	4825						