

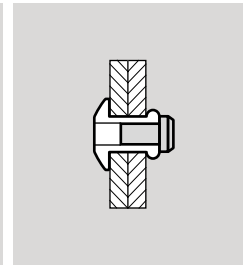

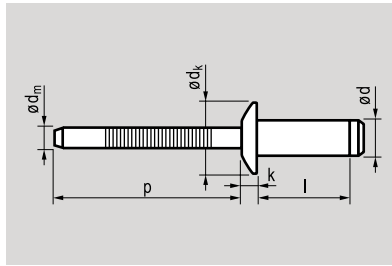

 **Steel**
Zinc plated

 **Steel**
Zinc coated

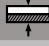
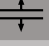
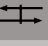

MASTERLOCK II | high strength | dome head

$\varnothing d$	l max.		Item nr.	$\varnothing d_k$	k	$\varnothing d_m$	p		
[mm]	[mm]	[mm]		[mm]	[mm]	[mm]	[mm]	[N]	[N]
6,4	12,5	2,8-4,8	15616412	13,6 max	3,3 max	~4,00	≥25	7.120	11.560
[+0,2/-0,1]	14,5	4,8-6,8	6414						
	16,5	6,8-8,8	6416						
Ø 6,65 [6,90 max]	18,5	8,8-10,8	6418						
	20,5	10,8-12,8	6420						
	22,5	12,8-14,8	6422						